

# ROOF & FACADE *Elastic*

## Hybrid sealant for exterior renovation and repair works



### WATER RESISTANT IN 2 HOURS

Due to Roof & Facade *Elastic* hybrid sealant's fast curing properties, it will fully bond with a wide range of surfaces and can be exposed to water in just 2 hours after application. Water will not affect its performance and the seal will retain its durability, adhesion and elasticity for many years.

### PAINT READY IN 1 HOUR

Using Roof & Facade *Elastic* hybrid sealant is the easiest way to achieve professional looking results when doing exterior renovation and repair works. Sealed surfaces can be spray-painted almost immediately and roller or brush-painted already 1 hour after application. This saves time and money as there is no lengthy waiting before painting.

### FOR ALL SURFACES, EVEN WHEN DAMP

Roof & Facade *Elastic* hybrid sealant adheres to majority of common construction materials. It provides excellent adhesion with sensitive and porous surfaces such as concrete, brick, roof tiles, wood and glass. Dampness of the surface will not affect Roof & Facade *Elastic* hybrid sealant's performance.

### 100% WEATHERPROOF

Roof & Facade *Elastic* hybrid sealant is used for weatherproofing around chimneys, pipes, roof gutter joints, exterior window and door frames etc. It guarantees total weatherproof seal even when exposed to structural expansions and contractions due to temperature fluctuations. Once the seal is fully cured, it is totally impenetrable and provides complete protection against water infiltration and humidity.

### UV-RESISTANT

Roof & Facade *Elastic* hybrid sealant maintains its flexibility and features even when sealed surfaces are exposed to the sun.

## WHY TO CHOOSE ROOF & FACADE *Elastic* HYBRID SEALANT

- High elasticity and movement capability, as good as any silicone
- Can be painted, compatible with most paints
- Non-corrosive
- Good adhesion to majority of common building materials, even to porous surfaces
- Excellent performance in any weather condition

### TECHNICAL DATA

PROPERTY	UNIT	VALUE
Basis		Hybrid Sealant
Density	g/cm <sup>3</sup>	1,45
Skin forming time	min	50 to 70
Curing rate	mm/24h	3 to 4
Resistance to flow	mm	0
Application temperature	°C	+5 to +40
Service temperature	°C	-40 to +80
Shore A hardness (ISO 868)		27 to 30
Elongation at break (ISO 8339)	%	>150

Declaration of Performance (DoP) is available on [penosil.com](http://penosil.com)

### APPLICATION AREAS

- Sealing and weatherproofing of chimneys, pipes, joints between metal and concrete, roof gutter joints, facade expansion joints, exterior window and door frames.
- Sealing of interior and exterior perimeter joints.

#### COLOUR



#### PACKAGING

290 ml cartridge,  
12 per box.



# ROOF & FACADE *Elastic*

### Hybrid sealant for exterior renovation and repair works

#### APPLICATION

Surfaces to be sealed must be clean and free from any dust, grease and old residues. It is recommended to clean the surface beforehand with a suitable product, according to the manufacturer's instructions. Surfaces to be sealed can be slightly damp but not wet, the product should not be applied during rain. Previously painted surfaces must be fully cured and sound.

After preparation, apply Roof & Facade *Elastic* hybrid sealant with a suitable caulking gun. Sealed surface should be smoothed by using a tool moistened with water. Smoothing is not only recommended for aesthetic reasons but also to ensure close contact and good adhesion. After smoothing, clean tools and product residue at once.

#### ADHERES TO

- CONCRETE
- BRICK
- PLASTER
- GALVANIZED TIN
- ROOF TILES
- WOOD
- CERAMIC TILES
- GLASS
- RIGID PVC
- MOST METALS and PLASTICS

#### LIMITATIONS

Do not use Roof & Facade *Elastic* hybrid as a glazing sealant, on bitumen surfaces or on building materials which might bleed oils, plasticizers, or solvents (e.g. natural or synthetic rubber, chloroprene, EPDM or flexible PVC). Does not adhere to polyethylene (PE), polypropylene (PP) or PTFE (Teflon®). Due to the wide variety of construction materials, we recommend a preliminary compatibility test.

#### SHELF LIFE

12 months in original, unopened packaging. Store in dry conditions, between +5 °C to +25 °C and protected from direct sunlight. Best before date shown on the packaging.

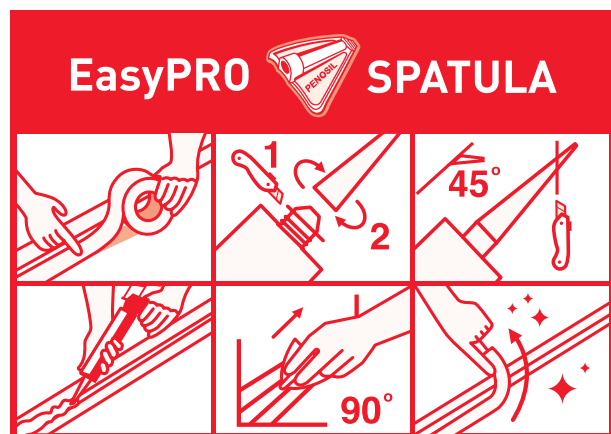

#### INDUSTRIAL TECHNOLOGY AVAILABLE FOR ALL

For over 45 years, PENOSIL's high performance products have been used in the most demanding environments to weatherproof and seal constructions. PENOSIL products are being used in industries such as aviation, nuclear power utilities, rail, automotive and shipbuilding.

#### Our products are popular with industries because they:

- provide efficient sound & thermal insulation
- have high elasticity
- cure fast
- provide excellent adhesion
- are easy to apply

At PENOSIL, we always challenge standards, commit to quality, and pay attention to the smallest detail. Now, we want to share our knowledge and to make sure that everybody can benefit from our high performing products.

We want consumers everywhere to feel warm and safe in their homes and we believe that the solutions we provide are the BEST for every HOME.

Detailed technical information can be found on [penosil.com](http://penosil.com)

PENOSIL is a registered trademark of Wolf Group.



\* Information sur le niveau d'émission de substances volatiles dans l'air intérieur, présentant un risque de toxicité par inhalation, sur une échelle de classe allant de A+ (très faibles émissions) à C (fortes émissions).